

SPLINTERS

Official Publication of THE VAN PETTEN LUMBER CO. Vol. 2

This is the time of a La Grande lumberman to start planning on fixing up the house, both inside and out. Protect the outside surface of your home with a couple of coats of CERTAIN-TEED house paint.

A new roof of shingles would give your home a covering of beauty and distinction. Let us figure with you.

"Jones always had a sense of humor, even at the time he kicked off."

"How was that?"

"He died in his living room."

"Get one little blue?"

She: "Chloroform."

Come down and see us. We have everything to build anything.

VAN PETTEN LUMBER CO.

Call us for an estimate.

BUILDING GAINS IN NORTHWEST

Oregon Cities Reporting Marked Gains for February Include La Grande.

Continued substantial gains in Northwest building over 1929 totals is forecasted today by Pacific Builder and Engineer, construction news publication with headquarters in Seattle. Gains will be marked in Washington and Montana, with possibly slight recessions in Oregon and Idaho, that publication announces.

The forecast is based on the trend indicated in January and February building permits, and in the rapidly mounting volume of contemplated building announced for 1930 construction. All statistics are based on definite announcements of projects appearing in the columns of Pacific Builder, and which will be summarized in that publication's edition of March 15.

"Fifteen representative Washington cities in February issued permits grossing \$4,825,755, a gain of 26.9 per cent over the state's total for February, 1929," it is pointed out by Walter A. Averill, editor of the Pacific Builder.

"In January, Washington ranked sixth among all states of the Union and Seattle was outranked only by New York, Chicago and Los Angeles.

"Montana's February total, despite cold weather, was \$288,725, not a large sum in itself, but almost five times the total for February, 1929, and eight times the January, 1930, figure. Great Falls led with \$258,325.

"Idaho's total of \$88,145 was twice that of January, 1929, and Oregon's total of \$826,286 was \$102,000 ahead of her January, 1929 figure, but both states are somewhat behind February, 1929.

La Grande Gains
"Oregon cities reporting marked gains for February are La Grande, Klamath Falls and Baker. La Grande and Klamath Falls also showed slight gains in January."

"That the gain of the first two months will be continued is indicated in the fact that from February 5 to March 10, inclusive, Pacific Builder and Engineer announced 73 buildings with an estimated total value of \$17,264,000 all contemplated for 1930, but none of which are included in the building permit totals announced above.

It is significant that this \$17,264,000 is in addition to buildings totaling \$10,954,500 announced by the trade paper in January, and that it is considerably larger than the January total.

Contemplated construction announced during February is summarized as follows:

State	No. Projects	Total Cost
Washington	16	\$15,152,000
Montana	7	285,000
Oregon	12	753,000
Idaho	8	574,000

Contemplated projects for Seattle alone totaled \$7,337,000. Yakima's total of \$820,000 indicates that conditions will continue as promising as indicated by January and February permits.

Value of Green Building contemplated buildings totaled \$169,000, more than one-half the Montana total.

Each of the 73 buildings included in the above totals is described in a summary appearing in Pacific Builder on the newsstands March 15.

BEDROOMS TO FIT IN CORNERS

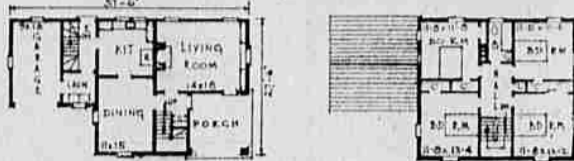

By the Associated Press
This house is designed for those builders who desire colonial characteristics combined with modern conveniences.

It is particularly suitable for a corner lot, with a frontage of not less than 50 nor more than 75 feet.

The square design has been utilized to provide conveniences for a fairly large family.

Each of the four bedrooms is on a corner, with cross-ventilation a feature of all. This arrangement is made possible by the side stairs. There is ample closet space, in addition to a sizeable hall upstairs.

A sequestered side porch adds to the attractiveness of the downstairs arrangement. The kitchen is intentionally secluded, opening only into the dining room.

If the dining room faces east, to catch the morning sun, the house has added cheerfulness. If the lot is sufficiently wide, a garden may be built so the living room will look out on it.

The garage in connection, according to the plans, naturally exits to a short road to the street.

The exterior is of brick on the first floor, with white clapboards on the second. The roof may be of various colored shingles if desired.

Taking labor and material costs into consideration, estimates on this house range from \$8000 to \$10,000. Costs ordinarily will range somewhat less in smaller communities.

branches also bearing heads. It requires the same treatment as cabbage or cauliflower.

Something new in the line of greens is offered in seed catalogs and has come into the winter markets from the south. This is the new "spinach" which is really mustard, the Florida broad-leaved mustard. It is the best of the mustard greens making big leaves six by ten inches and having the fine flavor of the old-time mustard greens, a favorite dish boiled with bacon.

Little squashes have taken popular fancy, the dark green heavily ribbed variety sold as walnut or nut squash having been a recent introduction. It is known as the "Puss Moines" in the trade. The thick flesh is of the best Hubbard quality. Half a squash baked is an individual serving. The skin is harder than the earlier sweet potato or banana squash but it can be split easily with a heavy butcher knife or cleaver. If no such kitchen tool is handy, the squash may be parboiled until soft and then cut in half and baked.

Improvement Gossip

Painting and Decorating—
H. F. Eitche finished painting and decorating the Fred Schilke house on 9th street last week.

New Garage—
C. E. Gump, of Pruitdale, is improving his place with a new two-car garage and concrete driveway.

Plastering—
Harry Hoffman will start the plastering of the Mackey building the first of this week.

Installing Plumbing and Heating—
Nate Zweifel is installing the plumbing and heating equipment at the Mackey building.

Home Water Systems—
A Fairbanks-Morse home water system was installed at the farm home of J. W. Knowles by Nate Zweifel.

Redecorating—
J. Miller is redecorating, including kalsomining, at the Grande House apartments.

Home Redecorated—
The home of Mrs. E. Jacobson on Greenwood has been redecorated by W. C. Peleberg.

Completed Wiring—
The wiring for The Little Shop was done by the H. and S. Electric company.

Construction Progressing—
Construction work is progressing on the Roesch building next to the Sacajawea Inn.

Receives Painting Contract—
The Bugg Paint company has received the contract to paint the Mackey building, doing both interior and exterior work.

Excavating—
Workmen are busy excavating preliminary to beginning construction on The Observer building, to be on Sixth street near the corner of Washington and Elm.

MODERN PLUMBING AN INVESTMENT— NOT AN EXPENSE

An investment in home happiness and comfort that enhances the value of your home.

Plans and estimates gladly given without obligation.

FRED SPAETH

MONTGOMERY WARD AND CO. ARE NEXT TO US

Look Over Our Want Ads for Bargains

NATIONALLY ADVERTISED

and guaranteed plumbing and heating materials combined with expert workmanship at reasonable prices, is the basis upon which we solicit your

PLUMBING AND HEATING

business. A trial will convince you that "Our Service is Different."

SHELLWORTH-GOECK

PLUMBING & HTG. CO.

212 Elm Street

PHONE MAIN 009

Ref. E. G. Nat. Bank and George Stage Depot.

LA GRANDE, ORE.

THREE PIECE BATH ROOM OUTFIT COMPLETE WITH FITTINGS \$69.50

1—Bath Tub
1—Lavatory
1—Closet Combination

All "Standard" Fixtures
All Fixtures Guaranteed

COME IN AND SEE OUR DISPLAY ROOM

NATE ZWEIFEL
1314 Jefferson Main 84

A Real Home is the HOME you own!

PRIDE of possession is never stronger or more fundamentally satisfying than in the man who owns his own home. He sees his wife and children flourish in the wholesome environment he has chosen for them; his working hours are enriched by ambition, his leisure hours by contentment.

LET US HELP YOU WITH YOUR PLANS

HOME LUMBER & COAL CO.

1802 Cove "QUALITY AND SERVICE" Main 218

Many Bargains Listed on Want Ad Page

Naturally...

MORE ECONOMICAL

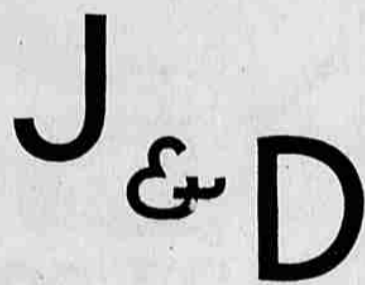

100% Pure PAINT

NO MATTER what your painting needs are J & D 100% Paint will satisfy your wants more economically! From the top shingle of your house to the bottom of the basement there is a J & D Paint, Enamel, Wall-Finish or Varnish made particularly for your special requirement.

Jones & Dillingham Co. have been making quality paints for over 38 years. Their paints preserve the beauty of your house because they present a tough, elastic coating that is impervious to the weather. Resists decay. Come in today and talk over your painting problems with us. Let us show you some of the J & D Color Cards. We'll be glad to give you free copies!

- J & D 100% Pure Liquid Paint
- J & D Four-Hour Floor Enamel
- J & D Porch and Step Paint
- J & D 4-Hour Enamel
- J & D Barn Paint
- J & D Shingle Stain
- J & D Sta-Name
- J & D Velva Wall
- J & D Varnishes.

NOAH'S PAINT STORE

1316 Adams Phone 457-J

Permit Issued For Observer's New Building

Building permits in La Grande for the year reached a new total of \$136,525 with the close of the records Saturday evening at the city building.

On Mar. 11, W. Yedder took out a permit for the erection of The Observer building on Sixth between Washington and Spring, the estimated cost being given as \$18,500. The building is to be one story with basement, constructed of brick and concrete.

Permits at the end of February totaled \$177,789, and so far this month the permits amount to \$18,745.

BUTTER AT
SAN FRANCISCO, Mar. 17 (AP)—Butterfat 1. a, b, San Francisco, 40 1/2c.

LIVERPOOL WHEAT
LIVERPOOL, Mar. 17 (AP)—Wheat close: Mar. 18 1 1/4 @ \$1.04 1/2. May: 78 1/4 @ \$1.07 1/2. July: 78 3/4 @ \$1.09 1/2.

The first two railroads built west of the Alleghenies have observed the 100th anniversary of their founding.

THE GARDEN

NEW VEGETABLES FOR VARIETY

Vegetables to vary the monotony of the staples of the menu are welcomed and the development of vegetable growing in the last few years has produced several novelties. One coming into more and more popular use is the Italian green sprouting broccoli. Broccoli, as commonly known before this introduction, arrived, was a variant of the cauliflower and practically indistinguishable from it when cooked.

Unlike the cauliflower, "the flower" of Italian broccoli is not an imperfect form as in the cauliflower, except that it is a fasciated stem, that is several stems and flower clusters grown together. The green "flower" part of the vegetable is a head of green buds of perfect flowers which when they stand too long in the market open into yellow blossoms similar to mustard. This vegetable is at its best when steamed. Sometimes if overboiled it loses its delicate flavor. Steaming develops it.

It is a delicate cauliflower flavor so far as it can be described although differing somewhat from cauliflower in taste. It is easily raised from seed and when the main head is cut develops side



WALLPAPER and PAINT

Form the Correct Background

YOUR lovely furniture and appointments, as well as yourself, require a distinctive setting... created in perfect taste by Bugg Paint Co. wall-coverings.

BUGG PAINT Co.