

This plat gives size, location and price of 2 choice home sites. Nearly 1/4 acres for \$300.00. Make your own terms. Buy in Riverside addition and be assured of a big profit in a short time.

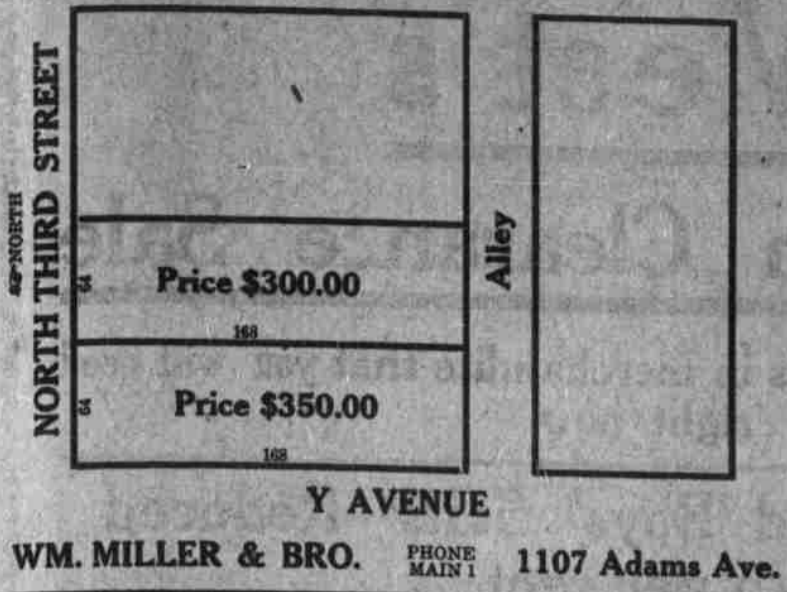

WM. MILLER & BRO. PHONE MAIN 1 1107 Adams Ave.

## BIG STEAMERS TO PORTLAND

(Portland Oregonian.)  
Control of 2,000 feet of the waterfront in what is known as Mocks bottom, on the east side, north of the plant of the Portland Flouring mills company, is sought on a basis that will make the purchase price total approximately \$1,000,000. Those holding the option are said to represent the Hamburg-American Steamship company. The company also has options on property at San Francisco. S. H. F. Doherty, Pacific coast agent, has departed from that city with plans and specifications to confer with his employers.

As at San Francisco the Mocks Bot-struction of a series of docks for commercial purposes, containing passenger facilities and an immense fill is to be made to the rear of a seawall that the entire tract, which has been regarded as almost worthless, may be reclaimed and a system of streets put in from the O. W. R. & N and Northern Pacific lines.

### Line to Cross Pacific.

The plan of the Hamburg-American system is to place in service a line of steamers from New York via the Panama canal to Pacific coast harbors, handling immigrants from Europe who are to cross the Atlantic by the service now maintained, and thence embark on the Pacific coast line. With that is a proposal to establish a trans-Pacific service to Yokohama and Asiatic ports. With the withdrawal of the Portland & Asiatic Steamship company from the field, through the transfer of its charters on four steamers to Frank Waterhouse & company, marine men assert that nowhere on the Pacific slope is there such a field for the establishment of a new oriental line as at Portland. While the Waterhouse interests have inaugurated a 20-day service with six steamers, Portland is virtually off the map in a sense, for the city has no direct service across the Pacific, the schedule providing for calls at Puget Sound ports both coming and going.

### Half of Island May Go.

It has been pointed out that in a comparative short time at least half of Swan island must be removed. The main road between the island and the east bank of the Willamette is too narrow to afford the best passage for heavily-laden steamers traveling in opposite directions, besides there is a turn that at times bothers pilots. For those reasons the removal of the island has been discussed and with a view to making the Mocks Bottom tract valuable the material dredged from the island could be pumped across the river and used for filling.

For six years the Hamburg-American operated steamers on the Portland Oriental route, the vessels being under charter to the Portland & Asiatic Steamship company, the last charter expiring in May, 1909. The steamers Arabia, Numantia, Aragonia and Nicomedia were first on the run, and the Alesia was substituted for the Aragonia. They followed the route of all vessels that sailed in the fleet, clearing from Portland for Yokohama and the usual Asiatic ports as far as Hong Kong.

Portland is the only port of prominence on the coast today that has not a permanent direct line across the Pacific, and the only one where passengers are not received. In former days, when the service was handled directly by the O. R. & N., now known as the O. W. R. & N., the steamers were operated direct and none sailed from the other side via San Francisco, and all carried passengers. As a result, large cargoes were discharged here and a portion from every steamer was routed by rail to eastern points.

## HORSE KILLED IN A PASTURE

Unless parents throw a heavy restriction over their boys and prevent them from taking guns to the hills the authorities of Union county are going to make some prosecutions that will be remembered. This was given out today in cold language when information was received that a valuable mare belonging to a young man by the name of Moon had been killed in the Williams pasture south of La Grande by a stray bullet from a boy's rifle. The mare was the mother of a four days' old colt and when a veterinary was summoned it was found necessary to destroy the mare to put her out of her misery from the wound inflicted by the boy's rifle. The colt also had to be killed for it could not subsist without its mother.

This is only one case, and there are others. But it is sufficient to arouse the officers and the boy who is seen with a gun in the future runs the strongest chances of being arrested and fined heavily.

Stray bullets do a great deal of harm and there is entirely too much live When once aroused there will be drastic action taken, according to many of stock in the hills to take any chances, the leading citizens.

### ACCIDENT, NOT SUICIDE.

Such Is Possible Solution of Sunnyside Tragedy This Week.

Coroner Ralph Folsom returned last evening from Milton, where he had been called by the violent death of Fred Geisler a Sunnyside rancher, says a Pendleton paper. By request of the widow an inquest was held but the jury failed to fix the responsibility of death beyond declaring that it was caused by a fall into a well at his fruit ranch two miles from Milton. Whether it was the result of an accident or of suicidal intent, the jury would not presume to say, inasmuch as no one witnessed the fatal fall.

In his story to the coroner's jury, the widow declared that when her husband arose from bed at midnight and brandished a hatchet over his head, she did not believe he had any intentions of doing her violence, but rather intended to take his own life.

She said she succeeded in taking the weapon from him, whereupon he walked toward the pumping house where there was a cot. She followed a little later, she said, to see if he had gone to bed, but finding the bed empty could only infer that he had fallen down the well.

Summoning assistance the well was dragged and her fears were confirm-

COMBINATION WATER AND WIND MILL FOR IRRIGATION OF ALL KINDS; CHURNS, WASHING MACHINES, ETC.

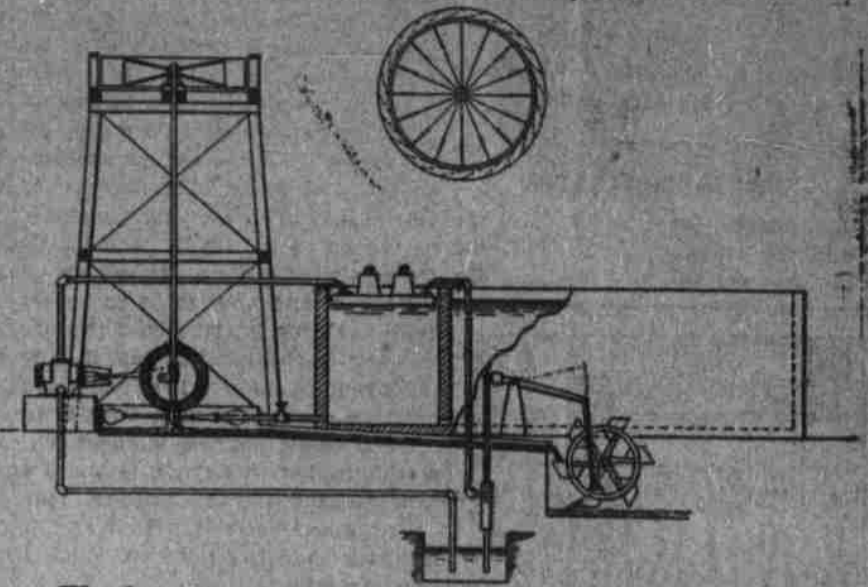

The latest and most complete machine on the market, used either by water or wind. Pumps from 1,000 to 10,000 gallons of water per hour.

Call on me before you let your work. We will save you money. Write for information to JOHN DYER, 1519 MONROE STREET. Cement Contractor.

## Savoy Hotel

EUROPEAN PLAN

The rooms are good and Steam heated only one block from depot

D. C. Brichoux, Prop.



Let your next corset be a Gossard. Have it fit to your form.

All the style, comfort and beauty of the lace-in-front Gossard will mean nothing to you until you try on one of these supreme corsets.

A single try-on will prove to you why they excel.

A complete line of Gossard corsets, bust confiners and pads, always on hand.

Prices of corsets \$3.50, \$5.00, \$6.00 and \$8.50.

Mrs. Robert Pattison Corsetiere. Phone Black 1481.

## C. T. Darley Cement Contractor

Consult him before letting your sidewalk

## 5 POUND TIN TOPS

CAR LOAD RECEIVED

at the

George Palmer Lumber Co.

Retail Dept. Phone, Main 8

## She Sacrificed

One sunny disposition  
One sound constitution  
One clear complexion

THE ALTAR WAS AN ANCIENT COOK STOVE. The Time—July and August—The rest of the family who called her mother saw what was going on when it was too late.

MORAL:—Don't permit any woman you care for to cook on anything but an Electric Range—especially during the torrid days of July and August. An electric range will do away with the drudgery of handling fuel and ashes, and will insure a COOL KITCHEN.

Eastern Oregon Light & Power Co.

## O'CONNELL'S Cigar Store

Pool, Billiards, Cigars, Tobacco and Soft Drinks—best and most complete line of cigars in the city.

Observer's Coast League baseball scores every day there's a game.

Corner Depot and Jefferson St.

## Classified Advertising

FURNISHED ROOMS—Modern. Telephone red 1571, 2002 Adams and Oak. 7-14-11tt

FOR SALE—200 White Leghorn single comb pullets. Hatched in March and April. Inquire A. J. Bishop, 2805 North Fir street. 7-19-22-24

FOR RENT—Six modern rooms. Telephone Main 89.

FOR SALE—Timber claim near railroad. Address Observer. 7-1 to 8-3

FOR SALE—Dry chain wood in any quantity. \$1.50 per cord at the Perry yards. Grande Ronde Lumber company Perry, Ore. 6-15-11

WANTED.—All the boys in La Grande between 10 and 13 years old to join the Boys' Savers' club. Call at the laundry and I will tell you all about it. A. B. Chrery, mgr. Cherry's New Laundry.

### BOYS

A TREASURE CHEST, full of hundreds of dollars in hard cash! The TRAIL to it, any wideawake boy can follow. Don't worry any longer where to get real money or whatever article you want. Come to me and get it. Parents investigate!—for this self-same RAD has led many a boy to a bank account. Come with

ed when the dead body with the neck broken was recovered.

She is not fully convinced that her husband jumped down the well, for she thinks that in the dark he may have stumbled over a pipe near the trap door which precipitated him into the opening. If it was suicide, the only motive she can ascribe is despondency, due to ill health.

your boy if you choose. Come early. M. Rosenbaum, 1402 Sixth street, La Grande, Ore. 7-20-11

FOR SALE—Furniture complete for five rooms. Also canned fruit, will sell all or any part of it. Inquire 1415 X avenue, between Greenwood and Fir streets. 7-20-21

KANSANS VIEWING COUNTRY Sunflower State Men Like the Grande Ronde Valley.

F. D. Nelson, H. Roger, John Clarke and James McFarland, all of Kansas, are in the valley looking over the crops. When seen at the Cove cherry show yesterday they expressed satisfaction over the general appearance of conditions here and there is a strong

possibility that they will locate in this part.

## Your Poultry Needs

Granulated Bone,

Oyster Shell,

Charcoal,

in order to do their best. We can supply you.

Waters-Stanchfield

Produce Co.

1426 JEFFERSON AVENUE

## Nutter

Paints as they paint in cities and makes reasonable charges. Consult him about your work.

Phone Red 971—next door to Observer office.

## GRANDE RONDE MEAT CO.

Uses only Refrigerator Counters and they show our cut meats in a most sanitary and appetizing way

TWO MARKETS - BOTH PHONES

## Bradley & Co.

Sanitary Plumbers.

REPAIR WORK A SPECIALTY.

PHONES: SHOP—BLACK 971. NEXT DOOR TO CITY HALL. RESIDENCE—BLACK 3482.