

State Faces Crisis in Higher Education

There are 74.2% more students in institutions of the State System of Higher Education than there were in 1940.

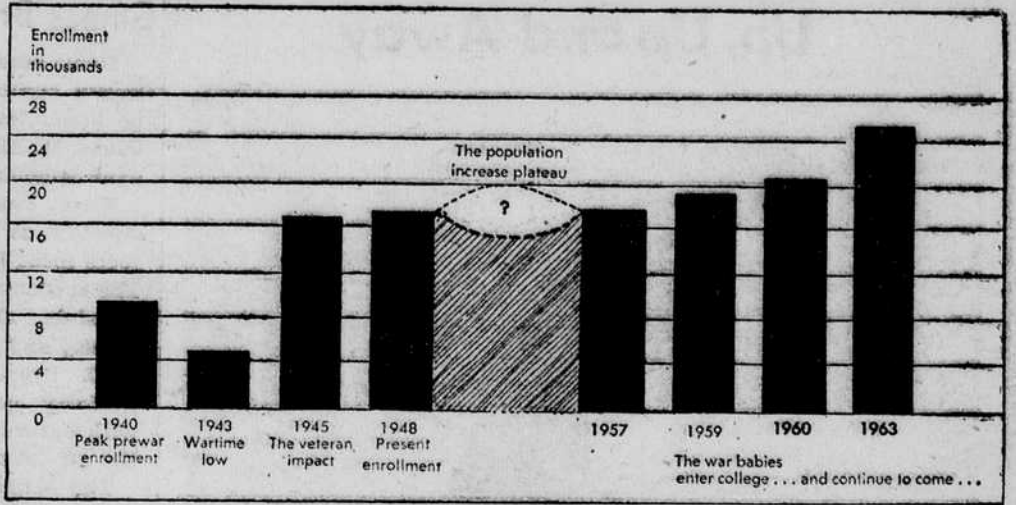
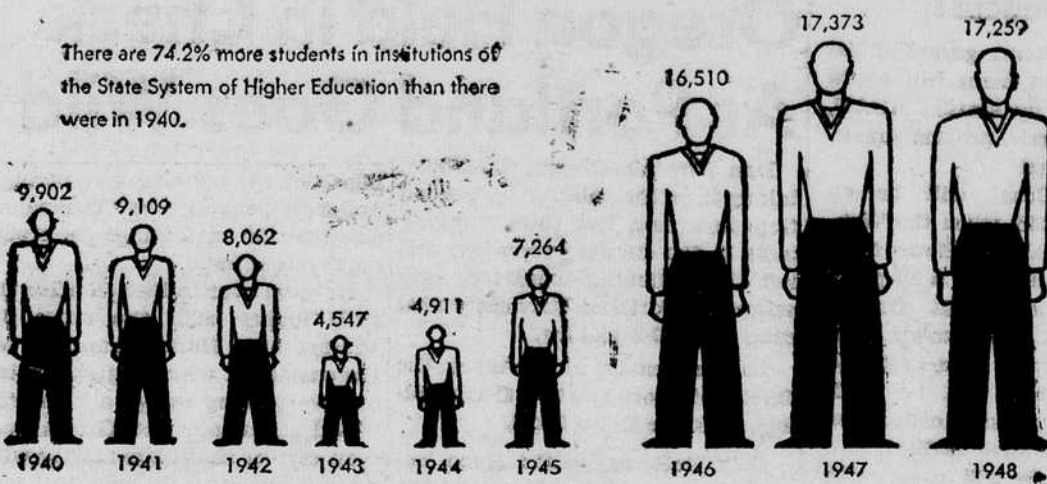

Out of the Past

The Shape of Things to Come

UO Stands to Gain In Registration; Needs More Room

By WALTER DODD

Oregon higher education today is at the crossroads of a new era. With a tremendous population increase, and enrollments double the prewar peak, higher education faces many challenging and complex problems.

Since 1940, more than 500,000 new Oregonians have been added to the population rolls to bring the total from 1,102,000 to 1,649,000, a 49.6 per cent population increase, far surpassing the per cent gains by other states.

Student body population has more than kept abreast of population increases. From a peak prewar student body of 3,705 the university has grown to a postwar peak of 6,149, a 66 per cent increase in the Duck brood.

For the state system of higher education as a whole, the student body has increased from 9,902 in 1940 to 17,259, a per centage of almost 75 per cent.

GI Total Decreases

The present high postwar enrollments are not temporary freaks caused by the engulfing tide of GI's. Enrollments in the state system of higher education for fall term 1948 are only 114 under those of the preceding year, yet the number of veterans has declined 1,095.

A continually growing Oregon is sending to its universities and colleges enough postwar students to take up the slack as veterans complete their education. A new peak has been reached, and this new level will maintain itself for years to come.

Estimates by the State Board of Higher Education expect enrollments in state system institutions to remain around the 17,000 level until about 1957, and then rise to approximately 22,000 in 1960 with the influx of war babies.

Enrollment Grows

This would increase the Duckling brood in Eugene to between 7,200 and 7,500, provided all institutions in the state system increased proportionately in size.

On the basis of the recommendations of the President's Commission on Higher Education some 40,000 Oregonians would be in state-supported institutions of higher education. This would mean 12,000 students at the University in Eugene.

Along with the postwar expansion, a 66 per cent increase in the student body, has come growing pains overcrowded classrooms, and educational facilities.

The University provides 99 sq. ft. of classrooms, laboratories, and office areas per student in permanent buildings. Including temporary buildings 115 sq. ft. of yawning and stretching space is available. Forty per cent of the physical plant of the university is temporary.

Space Recommended

The President's Commission on Higher Education recommends 175 sq. ft. per student and an essential minimum of 155 sq. ft.

Upon completion of the present building program, additions to Villard, the library and music buildings, 125 sq. ft. of both temporary and permanent buildings are available per student.

This represents only 81 per cent of the space required to meet essential minimum standards. A 24 per cent increase in classroom, laboratory and office space is needed to meet current requirements.

Board Asks Funds

The State Board of Higher Education has requested a legislative appropriation of \$12,175,000 to meet current emergency building needs to be distributed as follows:

THE PRESENT HIGH postwar enrollments are not temporary freaks caused by the engulfing tide of GI's. Educators are convinced that enrollment has leveled off and will remain at a record plane for many years. Along with growth has come signs of growing pains; overcrowded classrooms and educational facilities.

UO	\$ 3,500,000
OSC	5,175,000
Medical-Dental	2,500,000
EOCE	350,000
SOCE	350,000
OCE	300,000
TOTAL	\$12,175,000

The University request covers a science building, building additions for business administration and a new heating plant and heating tunnels.

The funds for OSC covers buildings for dairy manufacture, food industry, home economics, chemical engineering, and the first unit of an agricultural and biological building.

On the basis of a 6,500 enrollment in the university, 140 sq. ft. of temporary and permanent space per student will be available when the emergency building program is completed.

Will Still Lack Room

This emergency building program will still leave the University below the essential minimum recommended by the Commission on

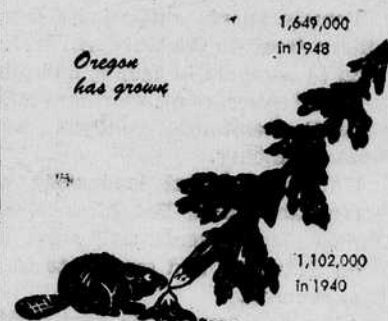

Higher Education to meet current needs and requirements.

To bring the physical plants of state institutions up to adequate minimum standards to meet current requirements would cost \$24,500,000. Of the total almost \$9,000,000 is to be spent at the University in Eugene.

Ten-Year Program

Such a building program is planned to cover a ten-year period. Additions are planned to architecture, journalism, administration, physical education, Condon, Chapman, and the women's physical education building.

On the basis of the ten year building program 167 sq. ft. of classroom, laboratory, and office space will be available per student.

Not until the completion of the proposed ten year building program will the physical facilities of higher education be sufficient to meet current requirements.

Three Exhibits Set for Gallery In AAA School

Three major exhibitions are scheduled for the Little Art Gallery in the Art school for spring term, according to Mark Sponenburgh, art instructor.

"Early American Arts and Crafts," the first exhibit, will be shown from April 12 to 24, and is being gathered in this area by J. D. Hatch, visiting professor of art. This will be followed by a traveling group called "A survey of American Sculpture," and will be made up of material from the Museum of Modern Art in New York, which will be supplemented by sculpture from the leading American museums illustrating the principal periods from 1700 to the present. This exhibition will begin with a formal opening on the evening of May 4, and will run through May 22.

The "Art School Annual," exhibition of work done by students in the school, will open June 11 and run through the summer.

Christian Science

Christian Science organization will meet Tuesday at 7:45 p. m. in the YWCA.

All connected with the University are invited to attend.

Spanish Movie

A Spanish movie will be shown today at 3:30 and 7 P. M., in 207 Chapman Hall. Cantinflas will star in "El Supersabio." Admission 25c.

Color Photography Browsing Topic

"Color Photography" will be the subject of a talk by Don Hunter, head of the audio-visual department of the University library, at the Ethel R. Sawyer Browsing room hour this afternoon at 4. Hunter will use colored slides to illustrate his talk, and will suggest worth-while books and magazines dealing with his subject. The talk is open to all students.

Spokane Meet Attracts Four

Four faculty members from the school of education will attend the Inland Empire meeting April 6, 7, and 8, in Spokane. Public schools and colleges in six western states will be represented.

Delegates from Oregon will include F. L. Stetson, professor of education and executive secretary of the Northwest Association of Colleges and Secondary schools; H. B. Wood, professor of education and president of the Northwest Curricula society which is meeting in Spokane; P. B. Jacobson, dean of the school of education, and R. G. Langston, assistant professor of education.

Principal speakers at the meeting will be Robert N. Hutchens, president, University of Chicago; Harold Benjamin, dean of the school of education, University of Maryland, and Professor Ethel Alpenfels, New York university.

Float Parade

Pairings for the Junior weekend float parade will be discussed at a meeting Thursday at the Alpha Omicron Pi house at 7 p. m., according to parade chairman Phil Patterson.

Every living organization has been requested by Patterson to send a representative to the meeting.

Hui O Kamaaina

An important Hui O Kamaaina meeting will be held Tuesday at 7 P. M., downstairs in Gerlinger Hall.

A \$24,000,000 Program Will Help

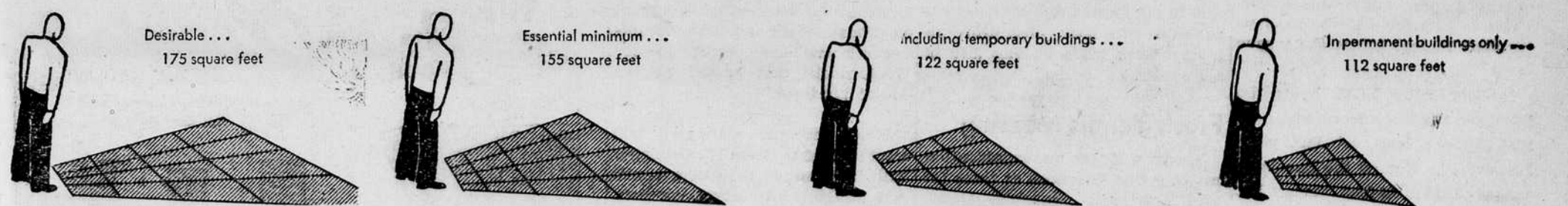

NECESSARY SPACE per Student Recommended by President's Commission on Higher Education.

ACTUAL BUILDING Space Available in Institutions of the Oregon State System of Higher Education.