

**Attack Possible**

# Troop Buildup Near Quemoy Concerns U.S.

WASHINGTON (UPI) — The White House said today the United States is "watching with concern" a large-scale Chinese Communist build-up of air and ground forces on the coast opposite Quemoy and Matsu.

Press Secretary Pierre Salinger told newsmen of this concern. He declined further comment on the situation, which some high U.S. officials described as a possible prelude to a Red attack against the two Nationalist-held islands.

Administration sources said reports on the Red build-up were being studied "with great interest." They would not hint at whether any steps were being contemplated by this country.

Officials theorized that the Red troop movement could be a defensive move sparked by recurring Chinese Nationalist threats to attempt an invasion of the mainland.

**Attack Is Possible**

But a high government source said the number and character of troops involved in the movement also was consistent with the theory

that the Communists might be planning an offensive.

Some officials felt Chinese Communist chief Mao Tse-tung might be preparing an assault on Quemoy and Matsu to distract U.S. attention from Southeast Asia.

Salinger had been asked to comment on reports that the administration was gravely concerned over this situation. He replied:

"It is a fact that the administration has been watching with concern the build-up of Chinese air and ground troops on the Chinese mainland adjacent to the offshore islands of Quemoy and Matsu."

Since taking office, President Kennedy has not expressed any stand on defense of Quemoy and Matsu—one of the hottest issues in his 1960 campaign against Richard M. Nixon.

In the campaign, Kennedy described the islands as indefensible.

**Cited Military Belief**

He said the islands, according to the best military judgment, had no strategic value and were not essential to the defense of Formosa, about 100 miles away.

**Jessie Keneda**

Jessie Lee Keneda, 82, died Wednesday at a local hospital following a short illness.

Mrs. Keneda was born Oct. 23, 1899, in Ennis, Tex. She had lived in the Roseburg area for the past two years, moving here from Glendale. She was married to Elmer H. Keneda Jan. 6, 1925, in Rule, Tex. Mrs. Keneda was a member of the First Christian Church of Haskell, Tex.

She is survived by her husband, Elmer of Roseburg; three daughters, Mrs. Treacial Fessler of Kalmath Falls, Mrs. Maxine Bowden of Roseburg and Mrs. Elizabeth Rasmussen of Glendale; two brothers, James Linville of Andrews, Tex., and Claude Linville of Haskell, Tex.; and six grandchildren.

Funeral services will be held at Wilson's Chapel of the Roses Monday at 2:30 p.m., with the Rev. Ralph Holseth of the Winston-Dillard Christian Church officiating. Concluding services and interment will follow at Glendale Cemetery.

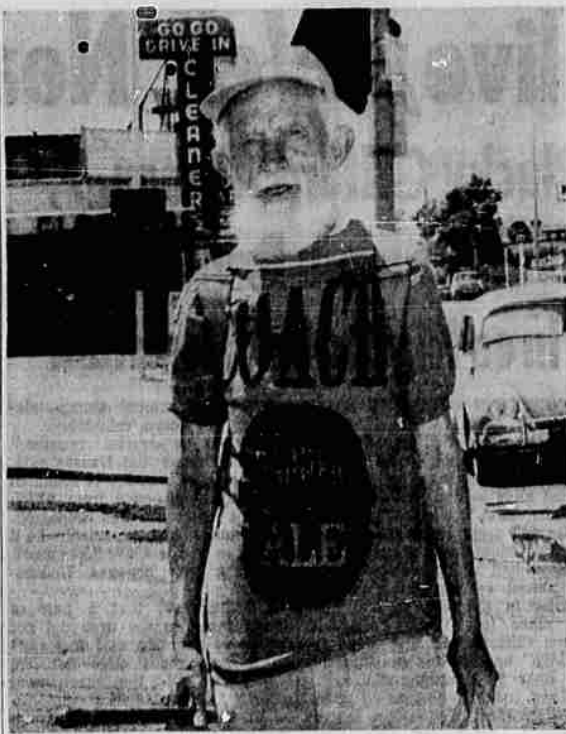

**JOHN C. STAHL**  
... "Old Iron Legs"

## Fair Walker Makes Roseburg Following Leisurely Stroll

John (Old Iron Legs) Stahl walked into Roseburg Wednesday at 11:30 a.m. after a leisurely stroll from Myrtle Creek which he had left at 6:30 in the morning.

Dubbed "Old Iron Legs" because he has done some walking in his time—nearly 18,000 miles, Stahl is on his way to the Seattle World's Fair. He's making the walk for the Rainier Brewing Co. in Seattle.

Stahl's first walkathon was from the Panama Canal Zone to Teas in 1939, a total of 3,500 miles.

He is contemplating a trip by foot to South America and back, enough miles to give him the equivalent of walking around the world.

**Stahl Is Coach**

Stahl is the "coach" of three other walkers, two of whom have already passed through Roseburg and arrived at the Fair. The third is taking the coast route.

Stahl, by the way, will be 80 years old Aug. 13, the date he will try to arrive in Seattle.

The only thing that seemed to bother him so far is a slight sunburn on the arms when he switched to a short-sleeved sweatshirt (bearing the "coach" title) and a few people along the way which he termed "stinkers."

A retired employe of the Post Office Department in San Francisco, Stahl has gained a lot of recognition for these little jaunts he's been making since 1939. He is an honorary Texas Ranger and a Kentucky Colonel, honors bestowed on him by the governors of those states. On this trip, he is carrying a letter with the official seal of George Christopher, mayor of San Francisco.

**Long Walk Made**

Stahl's first walkathon was from the Panama Canal Zone to Teas in 1939, a total of 3,500 miles.

He is contemplating a trip by foot to South America and back, enough miles to give him the equivalent of walking around the world.

## Fishing Said Good At Salmon Harbor

During the first week in which the county's Salmon Harbor at Winchester Bay has been officially open, the fishing is reported good.

However, Harry Ludwig, harbor manager, said right now the weather is not too good. Wednesday, fog settled on the bar and had not left at noon. There is some wind.

Ludwig said that charter boats are going across the bar and are bringing in salmon — mostly chinook. No skiffs are going out.

It was pointed out that sturgeon fishing below Reedsport is good. Fishermen unable to cross the bar because of weather consequently have been able to fish sturgeon.

**EXPERIENCING DEFLATION**

ARTESIA, N. M. (UPI) — Artesia is experiencing deflation. Price wars have cut gasoline prices to 24 cents a gallon and hamburgers to eight for \$1.

## Roseburg Man Injured As Auto Hits Grader

Rodger Gail Crabtree of 140 NE Garden Valley Blvd. was hospitalized with injuries following a collision in which his car ran into the rear of a grader Wednesday morning.

The accident occurred at the south end of the South Umpqua bridge in Roseburg on Highway 99 Freeway about 8:50 a.m.

Both vehicles were traveling south. The grader was operated by Enos Blackburn Miller of College Place, Wash. According to city police who investigated, Crabtree overtook the grader and failed to slow sufficiently to turn out to pass it and rammed the rear of the grader.

Miller said he had just reached the south end of the bridge and was preparing to pull onto the shoulder. Crabtree told officers he saw the grader, hit his brakes, started skidding and that was all he remembered. His injuries were not serious.

Billy Mohr ambulance took him to the hospital and his wreckers removed the vehicles.

**Lois A. Irving**

Lois A. Irving, daughter of an early pioneer family and former Douglas County resident, died in a Salem hospital this morning as the result of a stroke suffered Monday.

The 91-year-old woman was the mother of Ben B. Irving, Douglas County Water Resources Survey engineer. She had lived in Wilbur and Roseburg from 1917 to 1953 before moving to Salem.

She was born May 31, 1871, between Stayton and Mehama, Ore. on her father's donation land claim. Her father and mother had come across the plains by ox team in 1852. Her mother, a member of the John Mires family, had settled south of Oakland before marriage.

Mrs. Irving was married to Benjamin Irving Aug. 6, 1890, at Mehama. Irving died in Roseburg March 23, 1922, after having been principal and superintendent of the Oregon School for the Deaf.

Surviving beside her son, Ben, are: sons Robert L. of Salem and John A. of Tillamook and daughters, Jane C. Irving of Salem and Lois A. Hellwell of Roseburg; brothers Ray L. Stout of Portland and Luther Stout of Stayton; sisters, Miss Anna Stout of Salem, Mrs. Mary E. Mulkey of Salem and Mrs. Jessie Stephens of Paradise, Calif.; 12 grandchildren; and 21 great-grandchildren.

Funeral services are pending and will be announced later.



**NEW YORK EXECUTIVE** Edward M. Gilbert, left, leaves his lawyer's office in Rio De Janeiro Wednesday. In the center is his New York lawyer Arnold Bauman. At the right is an unidentified American friend. Gilbert has vowed to pay back every penny of the \$1.9 million he withdrew from funds of the E. L. Bruce Co. He blames the recent slump in the New York stock market for his financial troubles. (UPI Telephoto).

## Planning Group Approves Substation Site Request

The Roseburg Planning Commission has recommended approval of a request by Pacific Power & Light Co. for a proposed substation location on the Guy Hill property.

The site is located on property lying between Diamond Lake Blvd. and NE Douglas Ave., the U.S. Forest Service property and Todd Building Co. Subdivision No. 1.

A request by the utility for approval of a future substation site occupying block 5 of Sleepy Hollow Tracts also won commission endorsement.

No protests were submitted at a public hearing held this week on a proposed zone change for the strip portion of the James & Stritzke property located on the north side of W. Harvard Ave. between W. Shenandoah St. and W. Fair St. and containing a laundry and barber shop.

Approval Given

The commission recommended to the City Council that the property owners' request for rezoning the strip from residential 1 to business class 3 be approved.

A request signed by Myrtle B. and Fred T. Miller, Robert G. and Lorraine Smith and Frank and Maxine Carl requesting annexation of an area on the north end of NW Lynwood Dr. embracing lots 1, 9 and 10 of the First Addition to Lynwood Terrace was considered. The proposal would also take in a strip of land about 500 feet long and 150 feet wide running west of lot 1.

The commission said it is understood the property owners wish

to extend the existing 60-foot street west of NW Lynwood Dr. along the south boundary of this parcel and create approximately six building sites of about 80 by 100 feet each. Sewer service is proposed by extending the sanitary sewer on Lynwood Drive to the unnamed street and then to the west.

Acceptance Recommended

The commission recommended the council accept this proposal on 100 per cent petition and institute proceedings affecting the annexation.

The commission also recommended approval of a request by Jack Gamet for diagonal parking on W. Chatham Dr. south of W. Harvard Ave. "subject to a 30-day written cancellation by the council if future development in this area should make such diagonal parking undesirable."

## Driving Sans License Results In Fine, Jail

Leon Elbert Morgan, 38, of 1450 SE Jackson St., Roseburg, Wednesday pleaded guilty to operating a motor vehicle with suspended operator's license in Roseburg Municipal Court and was fined \$120, \$5 costs and sentenced to 10 days in the city jail.

He also was fined \$40 and \$5 costs for being drunk in a public place. Morgan was scheduled for appearance in traffic court Tuesday night but failed to appear. He later was picked up by city police on the drunkenness charge.

Total of 18 cases, including two trials were handled in Tuesday night traffic court. These included five for violation of the basic rule, five for no stop, three for no operator's licenses and the remaining miscellaneous.

James Earl Roberson pleaded innocent to two charges, one of reckless driving and the other for having no operator's license. He is to appear for trial next week.

## Dillard Church Slates Evangelistic Services

Evangelistic services will be conducted June 27 to July 4 at the Church of Christ in Dillard.

Milton Anderson of Wilmington, Calif., formerly of Canyonville, will conduct the services which will be held each evening at 7:30 p.m.

The public is invited.

## Arthur Charles Hink

Arthur Charles Hink, 68, of 4508 SW Stella St., Roseburg, died Wednesday night at the Veterans Administration Hospital.

He was born Feb. 7, 1896, at Durant, Iowa. He came to Roseburg two years ago from Boonville, Calif. He was married to Gladys Finney at Everett, Wash., July 19, 1920. He was a retired accountant, a veteran of World War I and a member of the Masonic Lodge of Alma, Wash.

He is survived by his wife, Gladys; four sons, Robert and Richard of Roseburg, Douglas of Chicago and John of San Jose, Calif.; two brothers, Roy Hink of Puente, Calif., and George Little Rock, Ark.; one sister, Grace Johnson, Rockford, Ill., and 13 grandchildren.

Funeral services will be held Saturday at 10 a.m. at the Long & Shukle Memorial Chapel in Roseburg, with Father Alfred Tyson officiating. Laurel Lodge 1037 will conduct Masonic rites. Interment will be in the Roseburg Memorial Gardens.

## Annual Red Cross Dinner Meet Slated

The annual dinner meeting of the Douglas County chapter of the American Red Cross is again scheduled this year at Castle Rock, the home of Mrs. Philip E. Johnson at Winston.

The event is slated June 28. A special hour will start at 6:30, and dinner will be served at 7:30.

New members of the board of directors will be introduced, and annual reports will be given.

The meeting may be attended by all people interested in Red Cross. Reservations can be made by calling the county Red Cross office at OR 3-9255.

**DU PONT '501'**  
Nylon Carpets  
And Quality Wool Carpets  
**BOB ALLEN**  
FLOOR COVERING  
Phone OR 2-1501

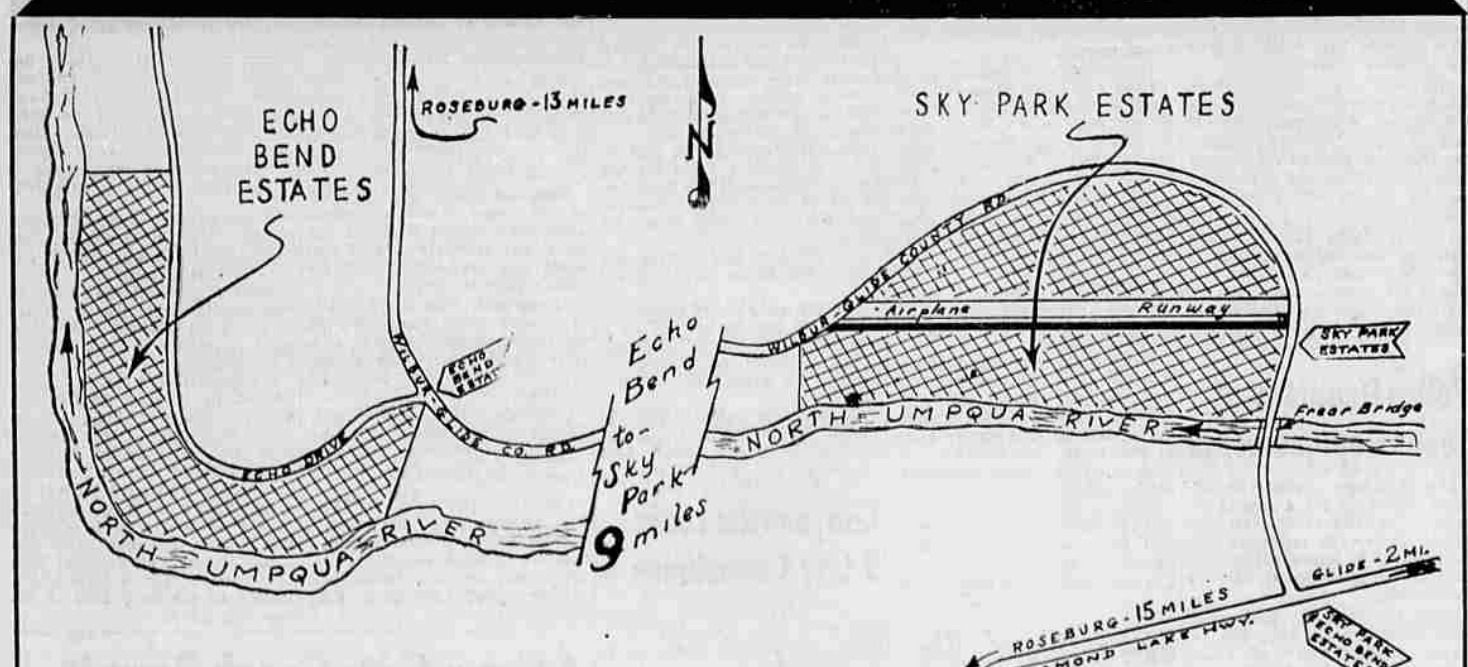

# YOU'RE INVITED...

to inspect a wide selection of beautiful new North Umpqua River front homesites in the sunshine Belt of Douglas County, East of Roseburg. Here you can swim, boat, fish, garden, or relax in the cool shade. For an immediate or future homesite, an investment in scarce property, or just week-end fun, these are tops. Flexible purchase terms to suit you. Prices from \$1,600 up.

There are two complete subdivisions, both located on the newly paved Glide-Wilbur road.

**ECHO BEND ESTATES** — 13 miles northeast. Cross tracks at Wilbur and continue 6 miles toward Glide. 21 tracts with a wonderful variety of sites and water. Very quiet ranch surroundings. These are 9 miles down river from Sky Park.

**SKY PARK ESTATES** — adjoining Frear Bridge, just off the Diamond Lake Highway, 15 miles East of Roseburg. 30 tracts — the only one in the Northwest with airplane facilities, a definite asset to the property, whether or not you are a flyer. Level, fertile land for gardening.

Bring your family out Saturday or Sunday and take a look around. We'll see you there.

**UMPQUA HOTEL**      **ROSEBURG REALTY**      PH. OR 2-3344

JOE DENT      PETE SERAFIN      JIM DOYLE      JOYCE DOYLE

**Preserve Fresh FLOWERS**

USE SILICA GEL FLOWER-DRI

Complete Instructions On How To Use	1 Quart . . . . . 2.95
	1 Gallon . . . . . 6.95

<b>Bamboo DROP SHADES</b> 2 1/2' to 12' Wide <b>79¢ to 3.98</b>	<b>Travelaire Portable ROOM COOLER</b> 1 and 2 Speed <b>39<sup>95</sup> to 49<sup>95</sup></b>
---	--

**5-PLAY GYM SET With Glider** 19.95

**WADING POOL 3-Ring, 70" X 16"** 7.88

**WADING POOL Wire Side, 8' X 20"** 18.88

**SWIM FINS Medium and Large** 2.98 & 3.98

**SWIM MASKS Now Only** 79¢ to 1.98

**BATHING SUITS & CAPS FOR ENTIRE FAMILY**

Top Quality Bedding <b>PLANTS</b> All Varieties TRAY <b>59¢</b>	Trailing or Upright <b>FUCHSIA</b> Good Selection Each <b>98¢</b>
--	--

**ODDS AND ENDS TRAY** Your Choice 39¢

**ORTHO DIBROM** Lawn Moth Control 2.98 to 8.98

**GARDEN HOSE** 1/2" nylon reinforced, reg. 5.98 4.88

**BAMBOO LEAF RAKE** Each 29¢

**Swing Lawn Sprinkler** by Avon, covers 2,400 sq. ft., SPEC. 7.88

**G & O PARK-N-SHOP**

SGOUTHGATE SHOPPING CENTER . . . OR 3-8423  
Daily 9-8    Plenty Free Parking    Sunday 9-7

**WHAT IS IT?**