

Serving the Sisters, Camp Sherman and Black Butte Ranch Areas



Ponderosa Properties LLC

The Locals' Choice!

REALTORS AND PROPERTY MANAGEMENT

541-549-2002

1-800-650-6766

www.PonderosaProperties.com

221 S. Ash St., Sisters



FABULOUS LOCATION...

...in Cascade Meadow Ranch with common area on 3 sides, overlooking the lake and meadow with a beautiful Black Butte view. This 3,237± sq. ft. home has an open greatroom floor plan with 4 bedrooms, 3 bathrooms, hardwood floors, custom cabinets, family room with gas stove and a large master suite with office and walk-in closet. Cascade Meadow Ranch offers open space, horse facilities, clubhouse and trails and is completely surrounded by U.S. National Forest only 2 miles from Sisters. For more information on Cascade Meadow Ranch visit www.cascademeadowranch.com. **\$699,000** MLS#201406208



SUN RANCH INN

Tourist Commercial zoned. Hotel, cabins, restaurant are all possible. This is an iconic property set amid old-growth trees, ponds and gardens offering Cascade mountain views. This is the ideal base-camp hotel for Central Oregon with access to mountain biking, fishing, golf, skiing, hiking, etc. Situated adjacent to the newly upgraded small airport, and ideal for fly-in guests. Area tourism is growing rapidly and this is a major opportunity. Seller/LLC representative is a licensed Broker in Oregon. **\$1,750,000.** MLS#201509877



SPECTACULAR SETTING

Simply stunning setting on Whychus Creek in Sisters with sunny exposure & lush greenery. Exciting exterior design invites entry to this newer, 3-BR, 2-BA, 1,701 sq. ft., well-cared-for single-level home with extensive creek views from most rooms. Greatroom design with vaulted ceilings and natural light. Gas fireplace, solid countertops, upscale fixtures. Wonderful master suite. Covered creekside patio. Located in a tranquil neighborhood just blocks from downtown Sisters, yet even closer to National Forest trails. **\$489,000.** MLS#201503600



SECLUDED ACREAGE...

...on the canyon overlooking the Deschutes River. Adjoins BLM land on 2 sides. This private sanctuary is perfect to design and build your dream home. Possible views. Just a hike down to Deschutes River below for excellent fly fishing and mountain bike trails near by. **\$195,000.** MLS#201410856



532 S. PINE MEADOW

Single-level, custom Craftsman-built home in Pine Meadow with lovely views of Black Crater. Three-bedroom, 2-bath, 1,920 sq. ft. home has numerous built-ins throughout. Propane fireplace, heat pump with forced air, private courtyard, Trex decking, French doors to wraparound covered porch, mature landscaping with drip irrigation. Kitchen island with new butcher-block countertop, slide-out cabinets, built-in desk, bar sink. Walk-in closets w/ organizers, utility room w/laundry sink, covered breezeway to 2-car garage; new custom doors. Great light! **\$429,000.** MLS#201600056

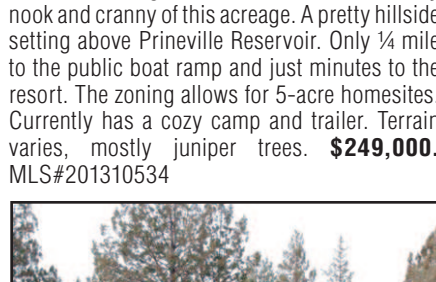

66979 CENTRAL STREET

Over 2 acres convenient to Sisters or commute to Bend. Build new frame home/modular, or remove manufactured home and your land value includes water and power. Septic permit 1983, pumped 2014. CCRs allow horses and cattle. Roof 2007±, Quadra Fire woodstove 2008. Monthly tenant \$850 wants to stay. **\$199,900.** MLS#201511590



GOLF HOME 245

Located on the 14th fairway of the Big Meadow Golf Course. Open greatroom floor plan with fireplace, hardwood floors, large master suite, loft and single garage. Four bedrooms, 3 bathrooms, 2,242± sq. ft. Large rear deck overlooks the golf course. Home is in a vacation rental program and can be rented when the owners are not using it. **\$549,500.** MLS#201503514



SEVEN CASCADE MOUNTAINS...

...will be some of your closest neighbors from this 5+ acre parcel. Level easy builder with your home, outbuildings and animals an out-right use. Easy access to everything that Central Oregon offers, and in the Sisters School District. **\$149,000.** MLS#201401852



BEAUTIFUL HOME IN CAMP SHERMAN...

...with exciting architecture and interior style. Extensive use of pine and log accents for mountain charm. Spacious kitchen facing multiple living rooms with fireplaces and lots of windows. Wonderful upper master suite with fireplace and patio facing into the forest. 4 additional rooms ideal as a combination of bedrooms, den/office or bonus rooms. Plenty of outdoor living area. Borders National Forest with easy access to the Lake Creek Nature Preserve. A very special 3-bedroom, 3-bath 2,672 sq. ft. home. **\$499,000.** MLS 201503499



BEAUTIFUL LOT IN CAMP SHERMAN...

...with a huge view of Black Butte, overlooking open space/meadow with southern exposure. Underground electric, telephone and water available, with paved street. Ownership includes common-area creek basin, seasonal swimming pool, tennis courts, trails and much more. Close to National Forest, the Metolius River, Hoodoo Ski Bowl and Black Butte Ranch golf. Year-round recreation available out your door. **\$149,500.** MLS#201507794

Bare Land...

.40±	Several mixed-use light industrial/mfg/live work. Walk to town.	\$107,000-250,000
.56	Brasada Ranch. Amenities (golf course, athletic club) 15 min to Bend. Prime PMV lots in a cluster. Plans available.	\$94,000 \$100,000/ea.
2.5	Several lots w/community water, power & phone. Treed privacy.	\$142,500-\$225,000
5.23	View of seven Cascade mountains. Level acreage.	\$149,000
.38±	Beautiful lot w/huge view of Black Butte, overlooking open space/meadow	\$149,500
4.76	Nice view of North & Middle Sisters. Level acreage. 325' deep wells.	\$154,000
1.03±	Stunning Cascade mtn. views. Level land. Incredible sunsets	\$164,900
.46	Outstanding location w/ponderosa pines. Upscale commercial area.	\$167,000
.16	West-facing lot w/mtn. view & pines. Includes full arch-plans for 2-story	189,500
2	Secluded acreage on canyon overlkg Deschutes River. Private.	\$195,000
.40±	Beautiful treed lot w/pines. Overlooking Lake Creek & Black Butte.	\$209,500
.76	Views of water. 1/4 mi to boat ramp. Zoning allows 5-ac homesites	\$249,000
8.93±	Existing well & approved for septic system in 2001.	\$295,000
11.05±	Existing well & approved for septic system in 2001.	\$395,000
157±	Secluded, ponderosas. Borders USNF. Off-grid/easy access. Deer range.	\$399,000
1.27	Premium lakefront. Nice pines & water views. 2 yrs. golf included.	\$479,000



Kevin R. Dyer
541-480-7552
CRS, GRI, Principal Broker



Rad Dyer
541-480-8853
ABR, CCIM, CRB, CRS, GRI,
Principal Broker



Carol Davis
541-410-1556
ABR, GRI, Broker



Catherine Black
541-588-9219
CRS, Broker,
Realtor Emeritus



Ali Mayea
541-480-9658
Broker, GRI, Green



Shane Lundgren
541-588-9226
Broker



Debbie Dyer
541-480-1650
GRI, Broker



Carrie Koepke
541-419-1575
Broker